

FOR LEASE

217 Grandville Avenue SW, Grand Rapids, MI

CUSTER OFFICE ENVIRONMENTS



Award winning contemporary loft space located in the Custer Office Environment Building. This is arguably the best looking first floor space in downtown Grand Rapids. All rates are quoted on a modified gross basis. Tenant improvement allowance is negotiable.

For more information please contact:

Jed Schildroth

Office Advisor
616.774.3500 ext. 180
616.745.4455 mobile
jed.schildroth@gepc.com

Chip Bowling

Office Advisor
616.774.3500 ext. 132
616.915.9080 mobile
chip.bowling@gepc.com

Chris Beckering

Office Advisor
616.774.3500 ext. 154
616.862.8918 mobile
chris.beckering@gepc.com



- **First Floor**
- **From 4,370 SF to 8,000 SF Available**
- **Lease Price/SF: \$16.00 to \$18.00**
- **Lease Terms: 60 Months**
- **Lease Terms: Modified Gross**

Features:

- Contemporary loft space
- Excellent for office or retail
- Tenant improvement allowance and professional space planning available
- Demographics:

Population

1 Mile:	15,126
3 Miles:	146,635
5 Miles:	268,015

Median HH Income

1 Mile:	\$ 28,098
3 Miles:	\$ 38,279
5 Miles:	\$ 42,587

Median Age

1 Mile:	28.5
3 Miles:	28.1
5 Miles:	30.0

Grand Rapids | Kalamazoo | Grand Haven | Holland

LOCAL PRESENCE GLOBAL REACH

For Lease
217 Grandville Avenue SW • Grand Rapids, MI 49503

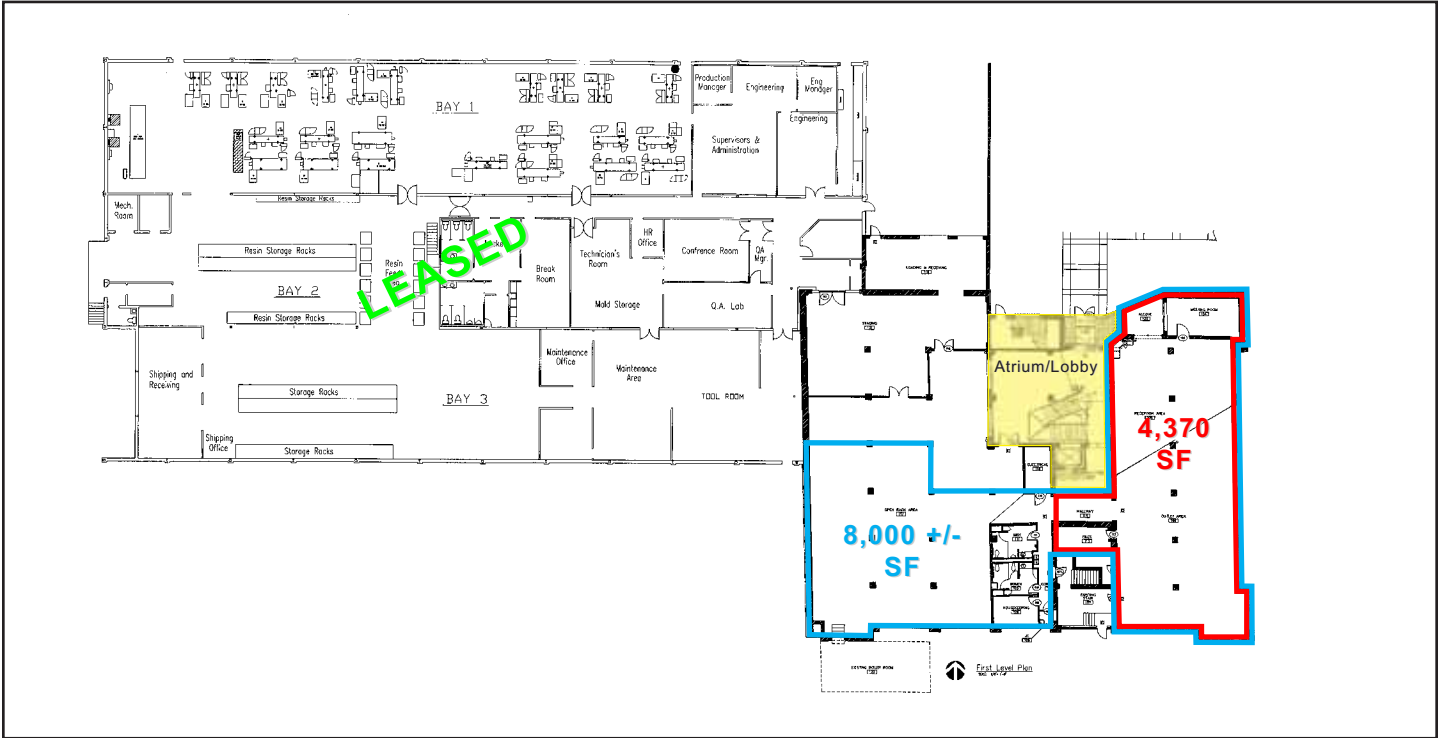

Grubb & Ellis | Paramount
 Property Solutions Worldwide Commerce

ParaCom LLC
 300 Ottawa Avenue NW Suite 400 Grand Rapids, MI 49503 616.774.3500 616.774.3600 fax www.gepc.com
 Independently Owned and Operated

01-13-09

The information contained herein was obtained from sources believed reliable; however, Grubb & Ellis|Paramount Commerce makes no guarantees, warranties or representations as to the completeness or accuracy thereof. The presentation of this property is submitted subject to errors, omissions, change of price or conditions prior to sale or lease, or withdrawal without notice.

LOCAL PRESENCE GLOBAL REACH